

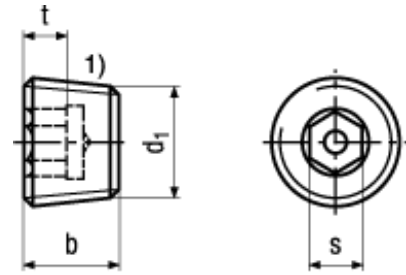



DIN 906



1) Cone 1:16

BN 41
Hex socket pipe plugs
pipe thread
Steel
zinc plated blue
• ~CSN 021913

! Hex socket pipe plugs DIN 906 are not intended to be used for gas and drinking water applications.



 Proper sealing is depended upon a given medium, pressure, temperature, and mating materials, therefore may not always be guaranteed.
Hence, based on the application, an appropriate sealing compound is recommended.

Article#	d ₁ "	s	t min.	b
1038850	R 1/8	5	4	8
1038869	R 1/4	7	5	10
1038877	R 3/8	8	5	10
1038885	R 1/2	10	5	10
1038893	R 3/4	12	6	12
1038907	R 1	17	6	12